

CARBON STEEL METAL EXPANSION JOINT WITH STAINLESS STEEL BELLOW BW

Carbon steel metal expansion joint with stainless steel bellow BW for high temperature networks.
Axial movement only.
With internal liner.



Size : DN25 to DN250
Connection : Butt Welding
Min Temperature : -20°C
Max Temperature : +300°C
Max Pressure : 16 Bars
Specifications : Axial movement
Stainless steel bellow
With internal liner

Materials : Carbon steel ends

CARBON STEEL METAL EXPANSION JOINT WITH STAINLESS STEEL BELLOW BW

SPECIFICATIONS :

- Axial movement
- Respect the flow direction indicated by the arrow
- Stainless steel bellow
- With internal liner
- Butt welding ends

USE :

- For high temperature
- Min Temperature Ts : - 20°C
- Max Temperature Ts :+ 300°C
- Max Pressure Ps : 16 bars (see graph)
- Axial movement only

PRESSURE / TEMPERATURE GRAPH (STEAM EXCLUDED) :

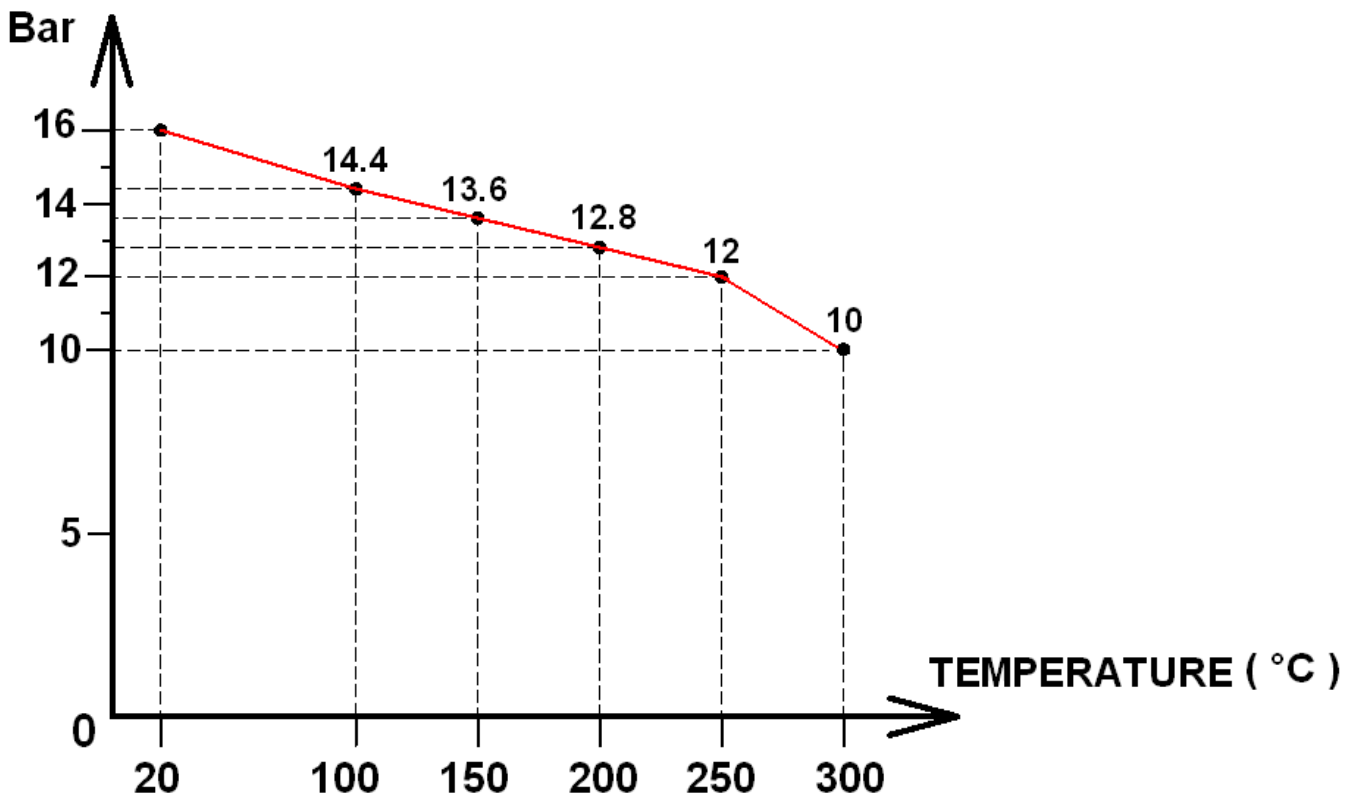

RANGE :

- Carbon steel expansion joint Butt Welding ends from DN25 to DN250

CARBON STEEL METAL EXPANSION JOINT WITH STAINLESS STEEL BELLOW BW

SPECIFICATIONS :

DN	25	32	40	50	65	80	100	125	150	200	250
Axial movement (mm)	± 11	± 10	± 13	± 20	± 20	± 25	± 32	± 33	± 40	± 33	± 40
Effective area (cm²)	14.8	18.9	23.7	37	58	79.3	127.9	183.9	267.9	436.3	704
Axial spring rate (N/mm)	87.1	52.7	64.5	75.3	69.2	107.5	113.6	170.2	88.5	312.8	227.8
Ply thickness (mm)	0.3		0.4			0.5	0.6			0.8	1
Number of convulsions	17			20	16	15	20	16	20	16	14

MATERIALS :

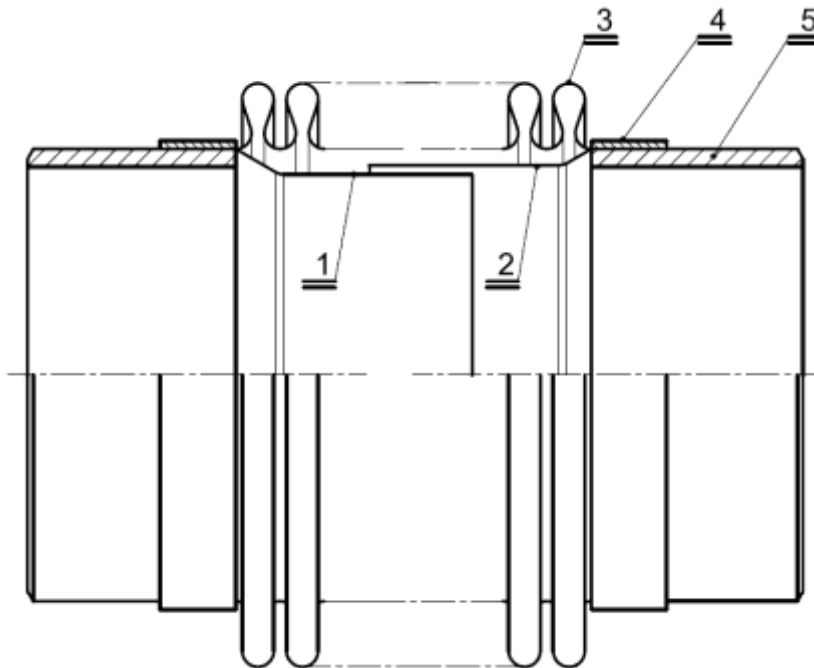

Item	Designation	Materials
1	Internal liner	AISI 321
2	Internal liner	
3	Bellow	
4	Band	
5	Ends	Steel St 37.2

CARBON STEEL METAL EXPANSION JOINT WITH STAINLESS STEEL BELLOW BW

SIZE (in mm) :

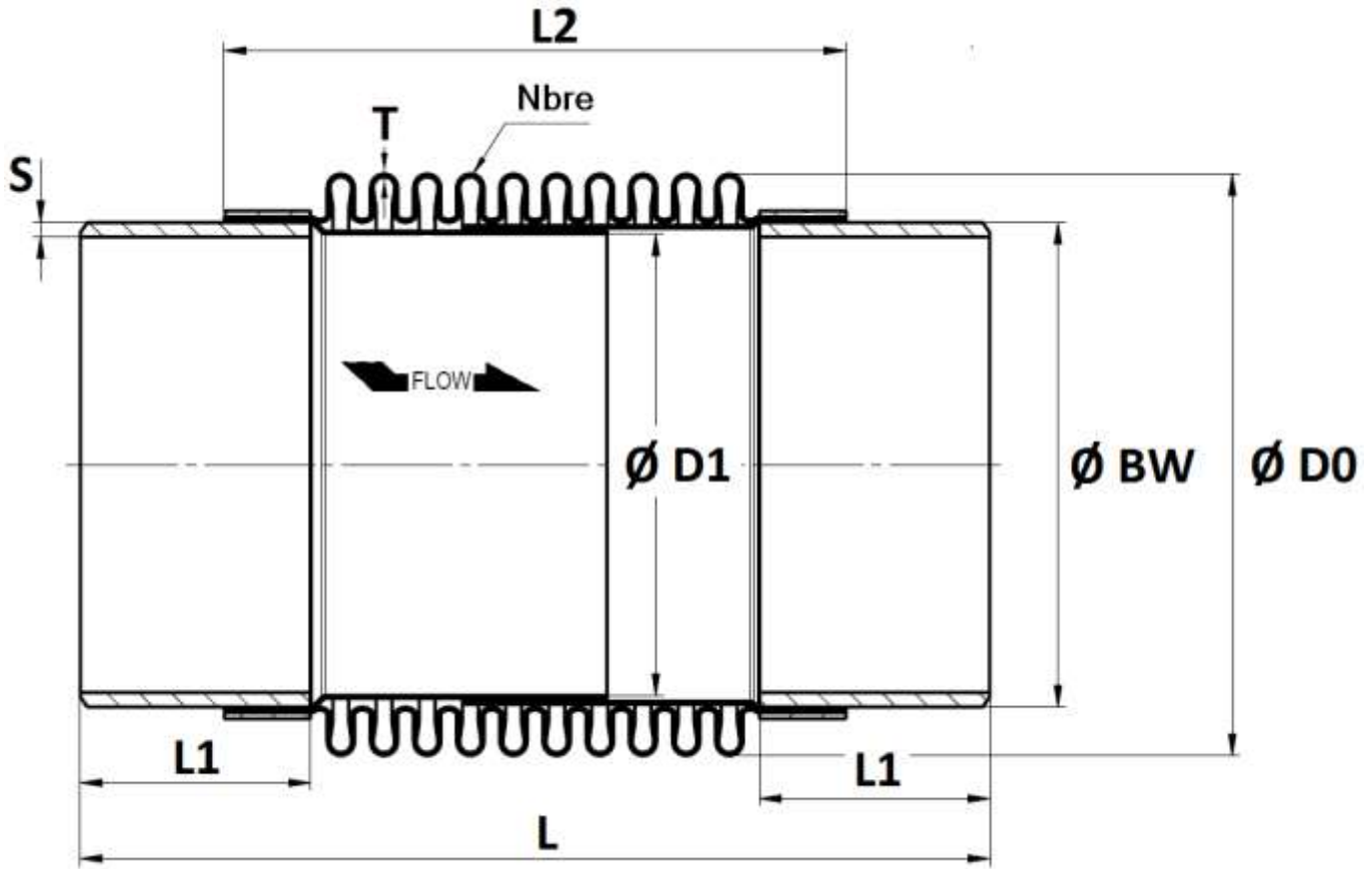

DN	25	32	40	50	65	80	100	125	150	200	250
L	185	185	200	270	260	275	310	310	350	330	360
L1	55	55	50	75	80	75	60	85	60	65	60
L2	105	105	120	140	120	145	210	160	250	220	260
Ø BW	38	42.4	48.3	60.3	76.1	88.9	114.3	139.7	168.3	219.1	273
Ø D0	48.8	55.6	61	77	96	112	141	165	201	252	325.8
Ø D1	32	36	41.4	53.5	70	78	103.5	127.3	156	207	261
S	2.6	2.6	2.6	2.9	2.9	3.2	3.6	4	4.5	6.3	6.3
T	0.3	0.3	0.3	0.4	0.4	0.5	0.6	0.6	0.6	0.8	1
Waves Nbre	17	17	17	20	16	15	20	16	20	16	14
Weight (in Kg)	0.37	0.44	0.53	1.11	1.37	1.86	2.94	3.89	5.85	9.4	13.97
Ref.	1511025	1511032	1511040	1511050	1511065	1511080	1511100	1511125	1511150	1511200	1511250

CARBON STEEL METAL EXPANSION JOINT WITH STAINLESS STEEL BELLOW BW

STANDARDS :

- Manufacturer certified ISO 9001 : 2015

- DIRECTIVE 2014/68/EU : For Liquids and Gas of Group 1
 - DN25 : Article 4, §3 (SEP), no CE marking
 - DN32-50 : Risk Category I, CE marking
 - DN65-200 : Risk Category II, CE0408 marking
 - DN250 : Risk Category III, CE0408 marking

- Designing according to EN 14917

ADVICE : Our opinion and our advice are not guaranteed and SFERACO shall not be liable for the consequences of damages.
The customer must check the right choice of the products with the real service conditions.